

PHILIPS

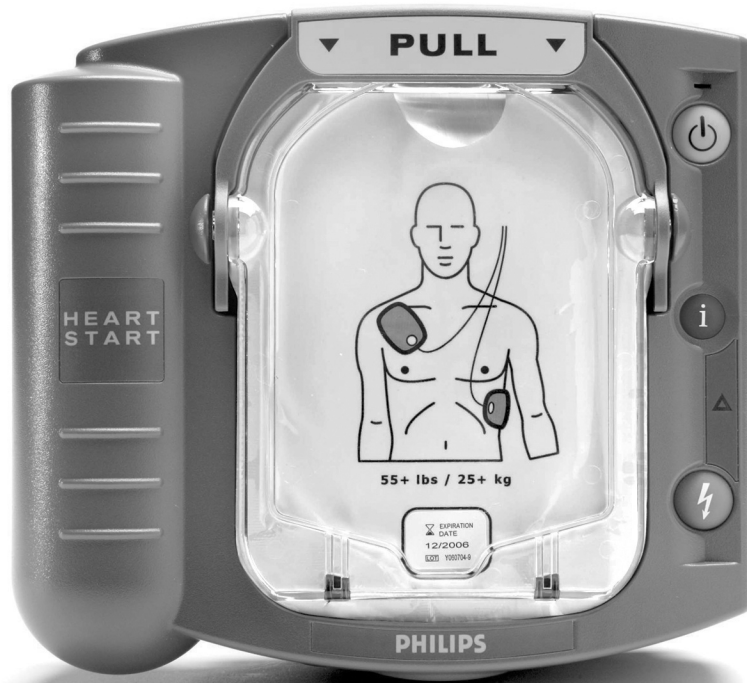

HeartStart OnSite Defibrillator

OWNER'S MANUAL

Guide to Set-Up, Operation, Maintenance, and Accessories

M5066A

Edition 7

HEARTSTART
DEFIBRILLATORS

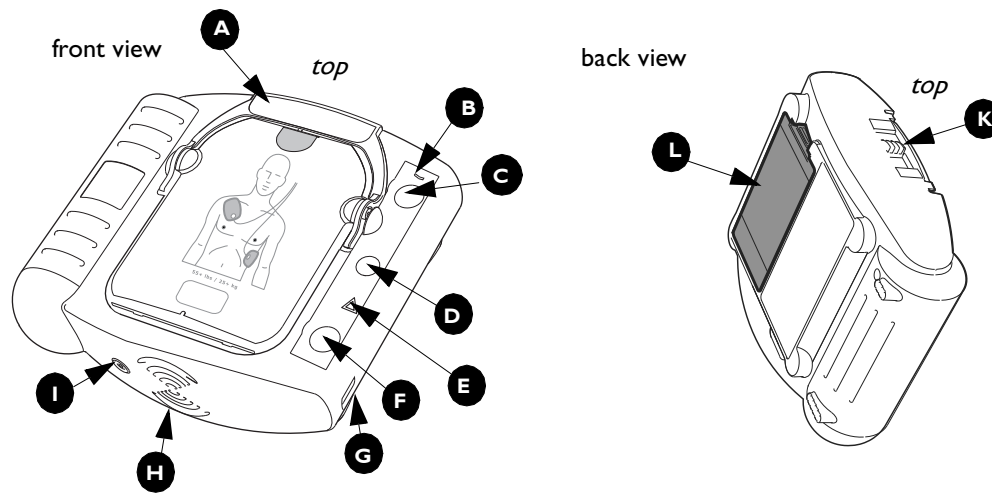

The HeartStart OnSite Defibrillator

A Pads Cartridge Handle. Pull the handle to turn on the HeartStart and remove the cartridge's hard cover.

B Ready Light. This green light tells you the readiness of the HeartStart.

Blinking: standby mode (ready for use)

Solid: in use

Off: needs attention (HeartStart "chirps" and i-button flashes)

C On/off Button. Press this green button  to turn on the HeartStart. To turn off the HeartStart, press the green button again and hold it down for one (1) second.

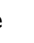
D Information-Button. This blue "i-button"  flashes when it has information you can access by pressing it. It also flashes at the beginning of a patient care pause when CPR Coaching is enabled.

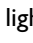
E Caution Light. This triangular light  flashes during rhythm analysis and is on when a shock is advised, as a reminder that no one should be touching the patient.

F Shock Button. When instructed by the HeartStart to deliver a shock, press this flashing orange button .

G Infrared (IR) Communications Port. This special lens, or "eye," is used to transfer HeartStart data directly to or from a computer.

H Speaker. When the device is being used, its voice instructions come from this speaker.

I Beeper. The HeartStart "chirps" through this beeper to alert you when it needs attention.

J SMART Pads Cartridge. This disposable cartridge contains self-adhesive pads with attached cable. Shown with adult pads cartridge.

K SMART Pads Cartridge Latch. Slide the latch to the right to release the pads cartridge for replacement.

L Battery. The disposable battery is inserted in a recess on the back of the HeartStart.

HeartStart OnSite Defibrillator QUICK REFERENCE

Check for signs of Sudden Cardiac Arrest: Unresponsive
 Not Breathing Normally

1.PULL

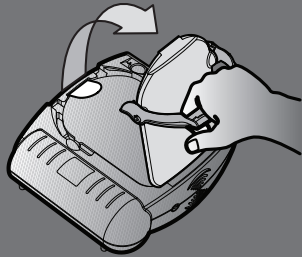

2.PLACE

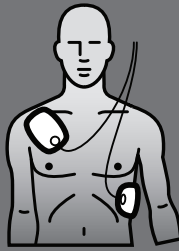

3.PRESS



Intentionally blank.

HeartStart OnSite

M5066A

Automated External Defibrillator

OWNER'S MANUAL

Edition 7

IMPORTANT NOTE:

It is important to understand that survival rates for sudden cardiac arrest are directly related to how soon victims receive treatment. For every minute of delay, the chance of survival declines by 7% to 10%.

Defibrillation cannot assure survival. In some victims, the underlying problem causing the cardiac arrest is simply not survivable despite any available care.

About this edition

The information in this guide applies to the model M5066A HeartStart OnSite Defibrillator. Its technical contents apply to all models in the HeartStart HSI family of defibrillators. This information is subject to change. Please contact Philips at www.medical.philips.com/heartstart or 1.800.263.3342 for information on revisions.

Edition history

Edition 7

Publication date: January 2007

Publication #: M5066-91900

Assembly #: 011666-0007

Printed in the U.S.A.

Copyright

© 2007 Philips Electronics North America Corp.

No part of this publication may be reproduced, transmitted, transcribed, stored in a retrieval system or translated into any human or computer language in any form by any means without the consent of the copyright holder.

Unauthorized copying of this publication may not only infringe copyright but also reduce the ability of Philips Medical Systems to provide accurate and up-to-date information to users and operators alike.

Authorized EU representative

Philips Medizin Systeme Boeblingen GmbH
Hewlett-Packard Strasse 2
71034 Boeblingen, Germany
(+49) 7031 463-2254

Caution

The Philips HeartStart OnSite Defibrillator is designed to be used only with Philips-approved accessories. The HeartStart may perform improperly if non-approved accessories are used.

Device tracking